

LCI-80

Line Control Display



The LCI-80 is a rugged, compact addition to the Line Control Instrument product line. It is an ideal product to replace panel meters and analog gauges in rotational applications. A perfect balance of size and functionality, the LCI-80 reflects Measurement Technology NW's extensive marine, construction, and industrial machine instrumentation experience.

Five fully-sealed pushbuttons within a heavy-duty 316 stainless steel front panel access an easy-to-follow English language menu for field calibration changes, I/O channel configuration, alarm settings, network settings, and screen layout – all intuitive and right at your fingertips.

Payout and line speed are displayed on a crisp, bright 160x80 electroluminescent (EL) display for unmatched readability in all light conditions. Two I/O data channels and serial networking capability provide flexibility in line monitoring or SCADA applications, and the LCI-80 can be linked with up to 32 LCI-80R displays to create a remote monitoring network.

**Monitor speed and payout in winch, crane, sheave, or any rotating shaft application. An ideal replacement for panel meters and analog gauges!
Use the LCI-80 wherever accurate and reliable line control is required.**

- Full programmability via English language menus.
- Four alarms, each independently linked to any high/low setpoint parameters.
- Configurable parameter position, scale, and units.
- Menu-based speed response tuning.
- Ethernet (USB) interface, network configurable.
- On screen calibration, diagnostics, and configuration security.
- Enclosure size: H3.9" x W5.6" x D2.5"
- Optional watertight rear enclosure.
- Two output relay channels, SPDT.

LCI Display Systems - For Superior Line Control

LCI-80 Line Control Instrument

Operator Interface Features

- Full programmability via English language menus
- Four alarms - link to any line parameter
- Two output relay channels, SPDT
- Configurable parameter position, scale, and units
- Save setting function (multiple)
- Internal temperature sensor
- Two digital inputs, functions are menu selectable
- Ethernet
- USB
- Network configurable
- On-screen diagnostics and configuration security
- Optional PC data logging interface

General Specifications

Display	160 x 80 graphic, EL Readable in all conditions
Enclosure Size	H 3.9" x W 5.6" x D 2.5"
Operating Temperature	-40°C to 70°C standard
Environmental	Weatherproof front panel Watertight rear enclosure option
Power	9-36VDC, 8W, fused/filtered Surge protected

Instrument Specifications

Sensor Excitation	Regulated 12 and 5 VDC, 0.5 A
Count Input	Quadrature, 1x, 2x, 4x Inductive proximity (Hall Effect) Count direction Up/Down 30 kHz Bandwidth
Digital Input	2 channels, 0-60VDC Trigger level 2.5VDC
Serial Communication	RS-485, isolated, 2 wire RS-232, USB, non-isolated
Output Relay	SPDT, NO-NC
Contact Rating	125VAC 60VDC & 1 Amp

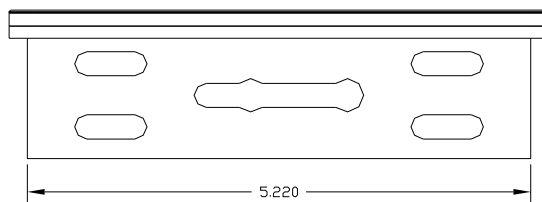
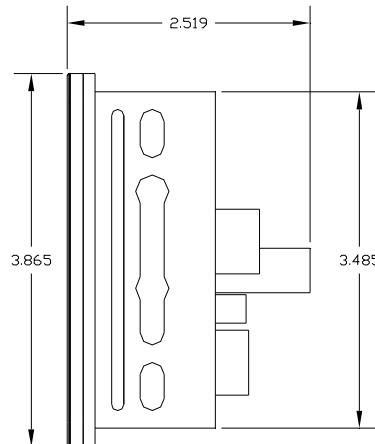
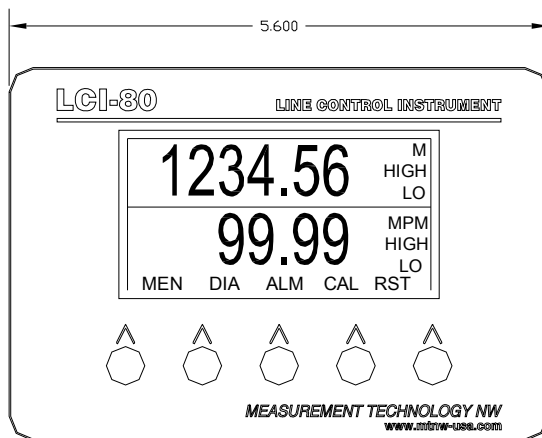

NOTES:

- 1: RECOMMENDED CUTOUT 5.27 X 3.55
- 2: ALL UNITS IN INCHES
- 3: PANEL MOUNT CONFIGURATION SHOWN



4211- 24th Avenue West
Seattle, WA 98199

Phone/206-634-1308
Fax/206-634-1309

www.mtnw-usa.com